

DISCATCHER®

WHEEL KIT FOR PORTABLE PRO28 TARGETS

Parts

- Two Brackets
- Two Wheels

Hardware

- Four Carriage Bolts
- Four ¼" Nuts
- One 5/16" Wheel Bolt
- One 5/16" Nut
- One Spacer

Assembly Tools needed

- 7/16" Wrench
- Two ½" Wrenches
- Two Adjustable Wrenches

Step 1

Ensure you have the correct base. This kit will fit bases with the rounded spoke ends shown in Figure 1. It will not fit bases with straight spoke ends shown in Figure 2.

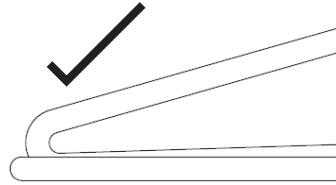

Figure 1. Base with Rounded Spoke Ends



Figure 2. Base with Straight Spoke Ends

Step 2

Assemble the two brackets using the top two carriage bolts, as shown in Figure 3, and install the nuts finger tight.



Figure 3.
Assembled Wheel Brackets

Step 3

Slide the assembled wheel brackets over the base spoke and hook the brackets on the base outer ring as shown in Figure 4. Install the remaining carriage bolts and nuts hand tight.

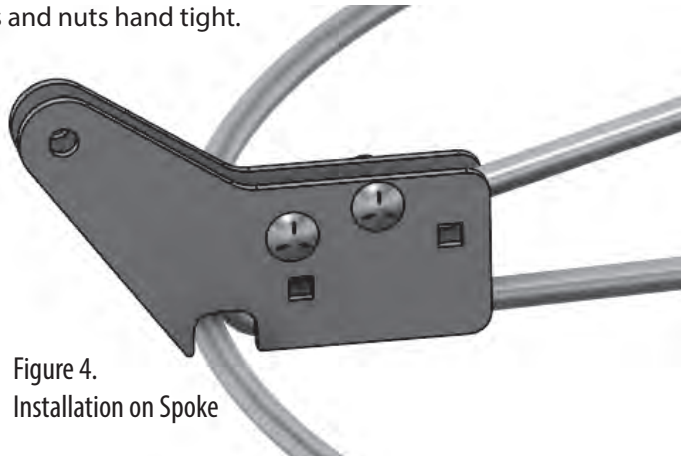

Figure 4.
Installation on Spoke

Step 4

Insert the long 5/16 wheel bolt through one wheel, then through the first wheel bracket, then the spacer between the brackets and the second bracket. Install the second wheel and 5/16" nut. Tighten the wheel bolt with the ½" wrenches. Figure 5 shows the order of the pieces. Tighten the lower two nuts on the carriage bolts with the 7/16" wrench then finally the top two nuts.

Note

if you are having difficulty tightening the carriage bolts you may flip one or two of the bolts to the other side to gain better access.

Figure 5.
Exploded View of Wheel Assembly

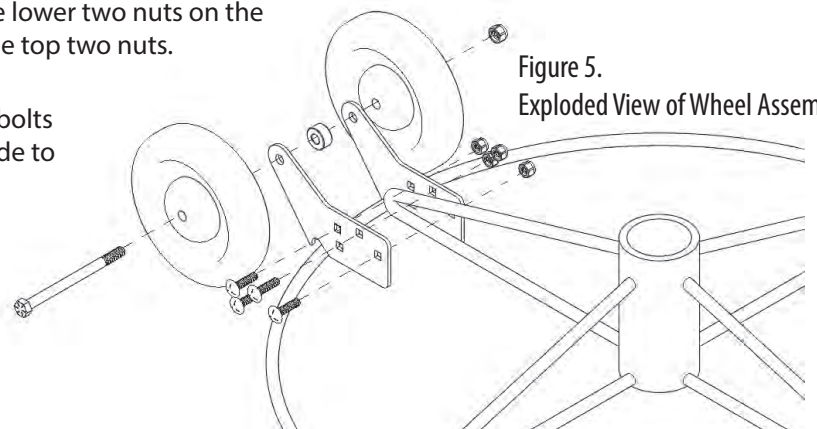

Still have questions? Give us a call.

West Coast Sales

(800) 408-8449
950 S. Dupont Ave.
Ontario, CA 91761

East Coast Sales

(800) 476-3968
2850 Commerce Drive
Rock Hill, SC 29730

Innova Canada

(604) 533-4453
20460 Langley Bypass
Langley, BC, Canada

Innova Europe

(372) 553-8065
Lao 8
Pärnu 80010, Estonia

DISCATCHER[®]

WHEEL KIT FOR PORTABLE PRO28 TARGETS

Parts

- Two Brackets
- Two Wheels

Hardware

- Four Carriage Bolts
- Four 1/4" Nuts
- One 5/16" Wheel Bolt
- One 5/16" Nut
- One Spacer

Assembly Tools needed

- 7/16" Wrench
- Two 1/2" Wrenches
- Two Adjustable Wrenches ^{or}

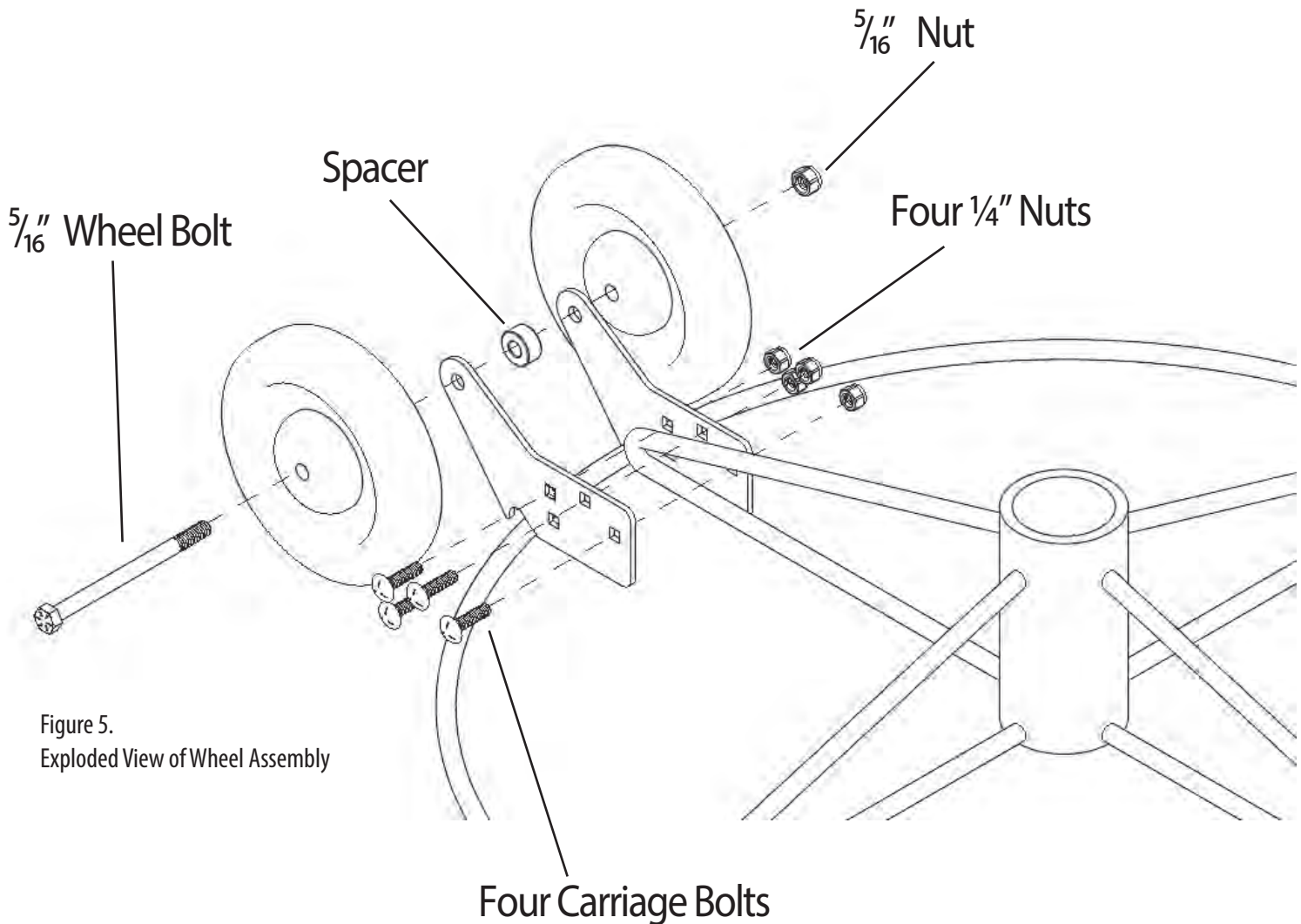

Figure 5.
Exploded View of Wheel Assembly



Still have questions? Give us a call.

West Coast Sales

(800) 408-8449
950 S. Dupont Ave.
Ontario, CA 91761

East Coast Sales

(800) 476-3968
2850 Commerce Drive
Rock Hill, SC 29730

Innova Canada

(604) 533-4453
20460 Langley Bypass
Langley, BC, Canada

Innova Europe

(372) 553-8065
Lao 8
Pärnu 80010, Estonia